

1110.001/002/031

**Vitamat RVP Saftzentrifuge**  
**Vitamat RVP Juice extractor**  
**Vitamat RVP Centrifugeuse pour jus**  
**Vitamat RVP Licuadora centrífuga**

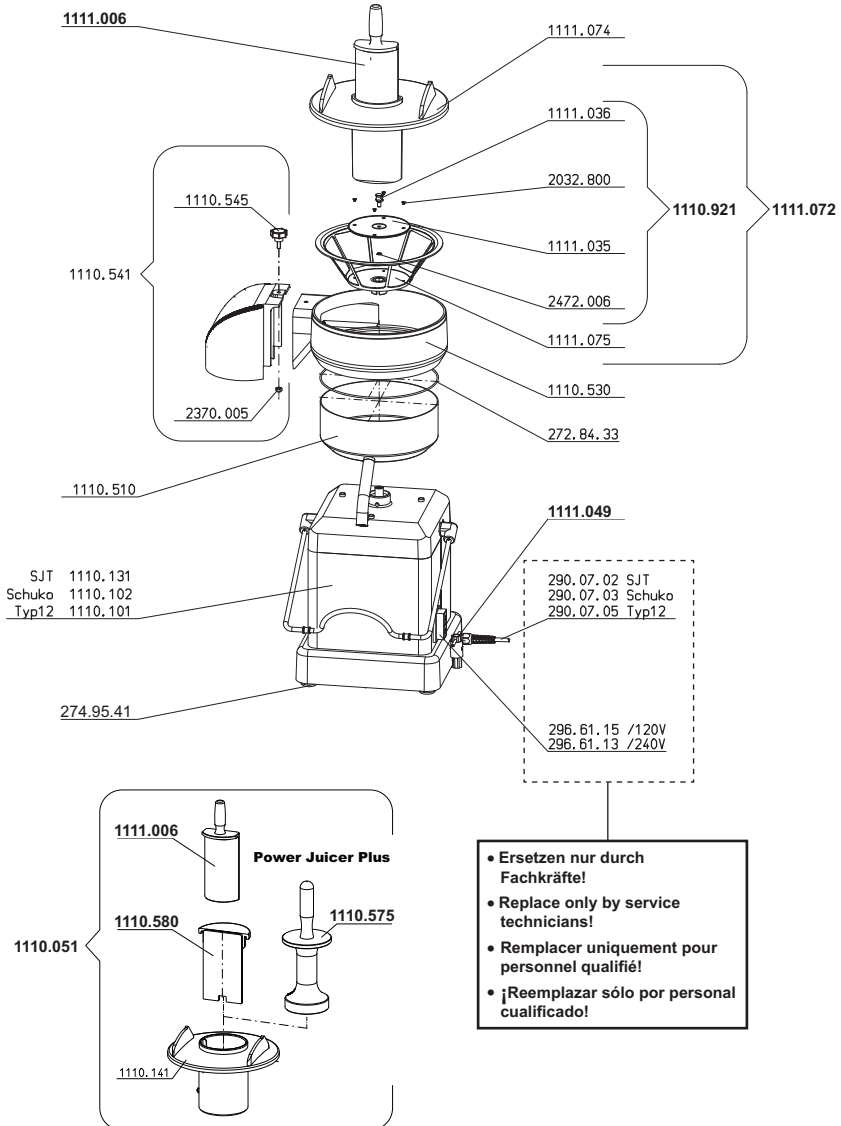

1110.001/002/031

**Vitamat RVP Saftzentrifuge**  
**Vitamat RVP Juice extractor**  
**Vitamat RVP Centrifugeuse pour jus**  
**Vitamat RVP Licuadora centrífuga**

Art.Nr./N°	Bezeichnung	Designation	Désignation	Designación
1111.006	RVT Stössel	RVT plunger	RVT poussoir	Émbolo RVT
1111.074	RVT Deckel poliert	RVT lid polished	RVT couvercle poli	Tapa pulida RVT
1111.036	RVT Spezialschraube	RVT special screw	RVT vis spéciale	Tornillo especial RVT
2032.800	Se-Schraube M3x4 mit Schlitz	slott. flat head mach. screw M3x4	vis à tête fraisée M3x4	Tornillo de cabeza plana M3x4
1111.035	RVT Reisscheibe	RVT grating disc	RVT disque râpeur	Disco rallador RVT
2472.006	Sicherungsscheibe RS4	lock washer	rondelle d'arrêt RS4	Arandela de seguridad RS4
1110.921	RVP Repair-kit Reisscheibe	RVP Repair-kit grating disc	RVP Repair-kit disque rapeur	Kit de reparación disco rallador RVP
2370.005	6kt-Mutter M6 ssi	Prevailing torque hex nuts M6	Eroux autoînés form basse M6	Tuerca exagonal autoînesada M6
1111.075	RVT Schleuderkorb pol.	RVT centrifugal basket asm.	RVT panier centrifugeur poli	Cesta centrifuga pulida RVP
1111.072	RVT Schleuderkorb kpl	RVT centrifugal basket asm.	RVT ens. panier centrifugeur	Conjunto cesta centrifuga RVP
1110.530	RVP Zwischenschling	RVP intermediate ring	RVP anneau intermédiaire	Anilla intermedia RVP
272.84.33	O-Ring 202,87x2,62mm	O-ring 202,87x2,62mm	O-ring 202,87x2,62mm	Junta tórica 202,87x2,62 mm
1110.545	RVP Sterngriff M6 z. Trestermaube	RVP lobe knob M6	RVP petit volant à lobes M6	Pequeño volante de lóbulos M6
1110.541	RVP Trestermaube	pulpe hood	hotte de marcs	Tubo de la caída de la pulpa
1110.510	RVP Auffangbehälter	collecting bowl	réceptier collecteur	Recipiente colector
1111.049	RVT Schlüssel	RVT boxspanner	RVT clé à douille	Llave RVT
296.61.13	Geräteschutzschalter 4,5A/240V	circuit breakers for equipment	interrupt. d'appareil 4,5A/240V	Interruptor 4,5A/240V
296.61.15	Geräteschutzschalter 8A/120V	circuit breakers for equipment	interrupt. d'appareil 120/8A	Interruptor 120/8A
290.07.03	Netzkabel 3x0,75mm2x2m (Type 12)	cord with plug (type 12)	cordon avec fiche (type 12)	Clavija y cable (tipo 12)
290.07.05	Netzkabel 3x0,75mm2x2m (Schuko)	cord with plug (Schuko)	cord with plug (Schuko)	Clavija y cable (tipo Schuko)
290.07.02	Netzkabel 3x18AWGx2m (SJT)	power supply cord with plug (SJT)	cord with plug (SJT)	Clavija y cordón 120V (SJT)
1110.101	RVP Motorblock 230V kpl.	RVP motor base 230V asm.	RVP ens. bloc moteur 230V	Conjunto bloque motor 230V RVP
1110.102	RVP Motorblock 230V kpl.	RVP motor base 230V asm.	RVP ens. bloc moteur 230V	Conjunto bloque motor 230V RVP
1110.131	RVP Motorblock 120V kpl	RVP motor base 120V asm.	RVP ens. bloc moteur 120V	Conjunto bloque motor 120V RVP
274.95.41	Gummifuss d30x18	rubber foot d30x18	piéd en caoutchouc d30x18	pie de goma d30x18

## PowerJuicer Plus

1110.051	RVP Spezialrichtung	RVP special version	version spéciale	versión especial RVP
1110.141	RVP Deckel-Rundschaft kpl.	RVP lid-round feet shoot asm.	RVP ens. couvercle goulotte ronde	Conjunto tapa-cañon de llenado RVP
1110.575	RVP Rundstößel kpl	RVP round plunger asm.	RVP poussoir ronde	Émbolo redondo RVP
1110.580	RVP Einsatz-Rundschaft	RVP inset-round feet shoot	RVP accessoire demi-lune	Accesorio a media luna RVP
1111.006	RVP Stössel	RVP plunger	RVP poussoir	Émbolo RVP

**A2. CONNECTION DIAGRAM 230 V**

**FOR SERVICE TECHNICIANS USE ONLY**

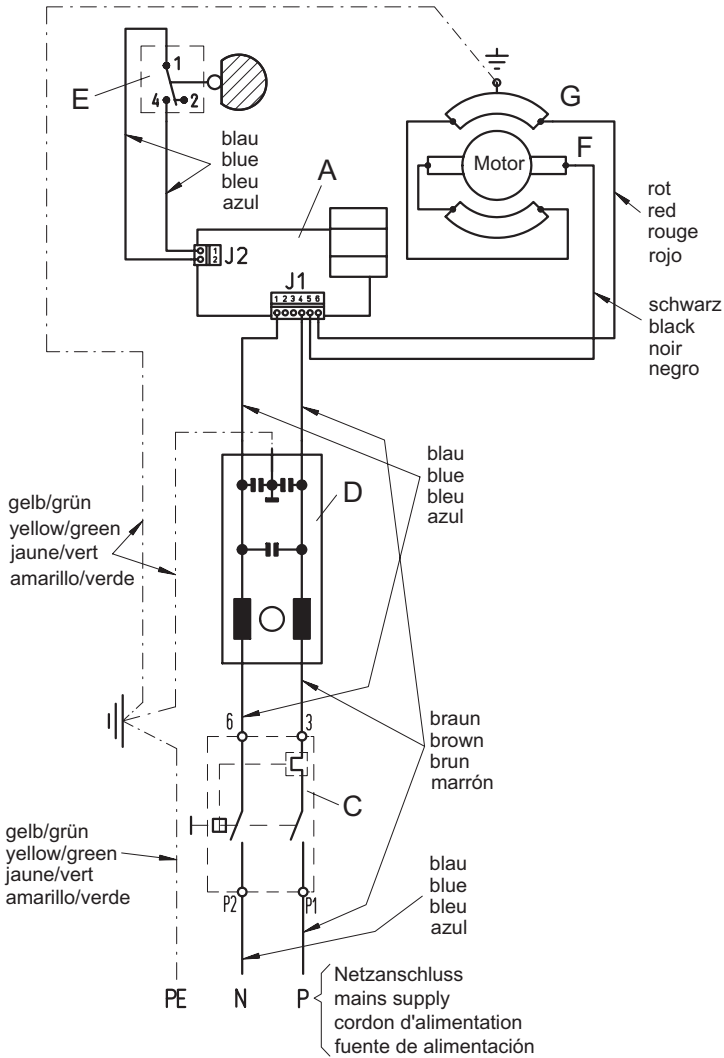

A = P.C. board  
 J1, J2 = Main cable terminals  
 C = Equipment circuit breakers  
 D = Radio interference filter  
 E = Safety switch  
 F = Carbon brush connection

G = Stator connection  
 PE = Earthing  
 N = Zero conductor  
 P = Phase

**A2. CONNECTION DIAGRAM 120 V**

**FOR SERVICE TECHNICIANS USE ONLY**

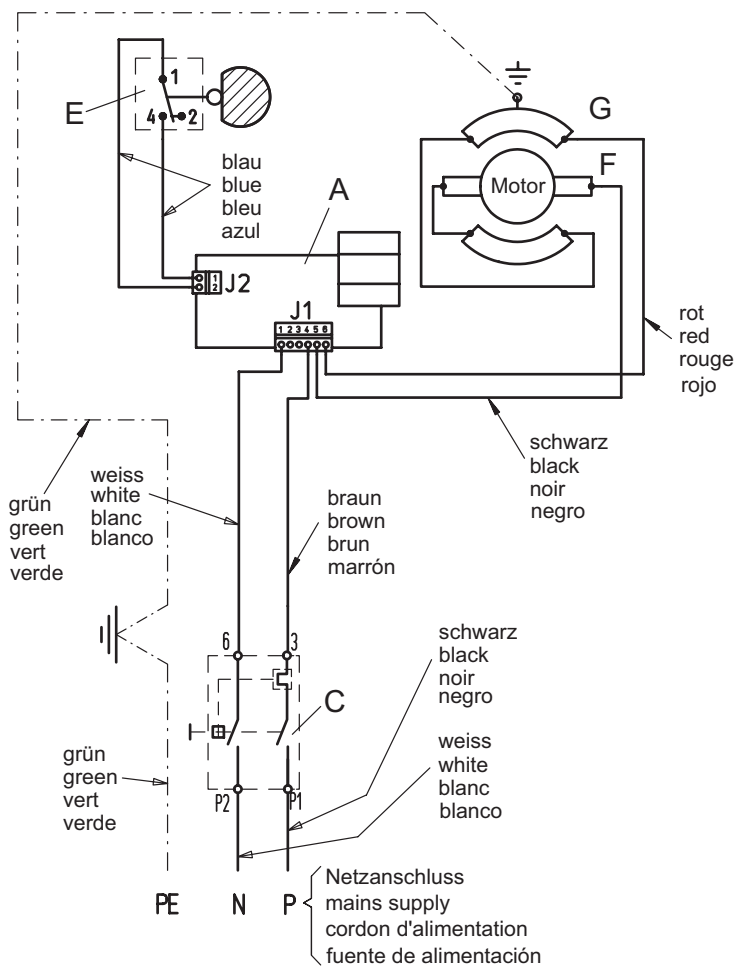

- A = P.C. board
- J1, J2 = Main cable terminals
- C = Equipment circuit breakers
- E = Safety switch
- F = Carbon brush connection

- G = Stator connection
- PE = Earthing
- N = Zero conductor
- P = Phase